



Fused & Switched IEC Inlet Prewired 1.2mm



Order code: **710-167**

Specification

Material:

1. Housing: PC, UL 94V-0
2. Terminal: Copper alloy, tin plated

Characteristics:

1. Rating: 10A 250V
2. Insulation resistance: 100M Ω min. at 500V DC
3. Electric strength: AC 2000V for one minute
4. Fuse: \varnothing 5 x 20mm

Equivalent Circuit:

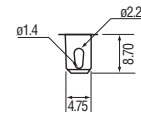
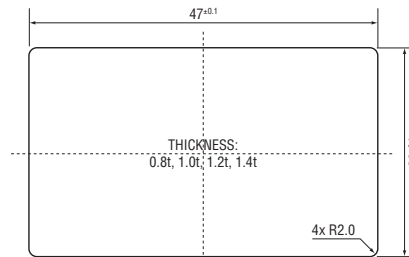
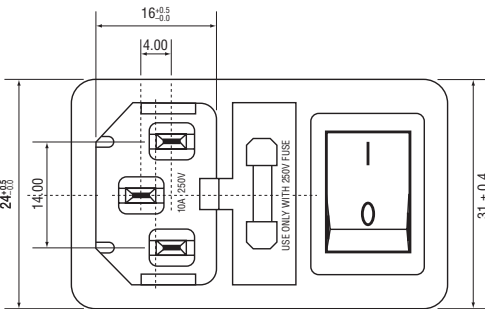
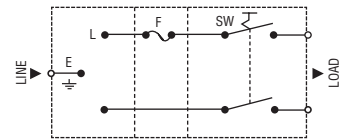

NOTE 1: XX = Panel thickness in 1/10mm, i.e. 0.8, 1.0, 1.2, 1.4

PANEL CUT-OUT

